

**DESIGN NOTES**

- STRUCTURAL STEEL SECTIONS, PLATES AND BARS TO CSA-G40.21, GRADE 300W
- HSS SECTIONS TO CSA-G40.21, GRADE 350W
- WELDING MATERIALS TO CSA-W59
- ELECTRODES TO CSA-W48
- BOLTS, NUTS AND WASHERS SHALL BE SUPPLIED BY OTHERS
- CONSULTANT TO SPECIFY BREAKAWAY BOLT GRADE AND MATERIAL
- FIXED BOLTS SHALL BE CLASS 70 OR HIGHER STAINLESS (i.e. 304-70)
- ALL METALS SHALL BE HOT-DIPPED GALVANIZED EXCEPT FOR STAINLESS STEEL ITEMS
- ALL JOINTS SHALL BE FULLY-WELDED

**GENERAL NOTES:**

1) ALL UNITS IN mm UNLESS NOTED OTHERWISE

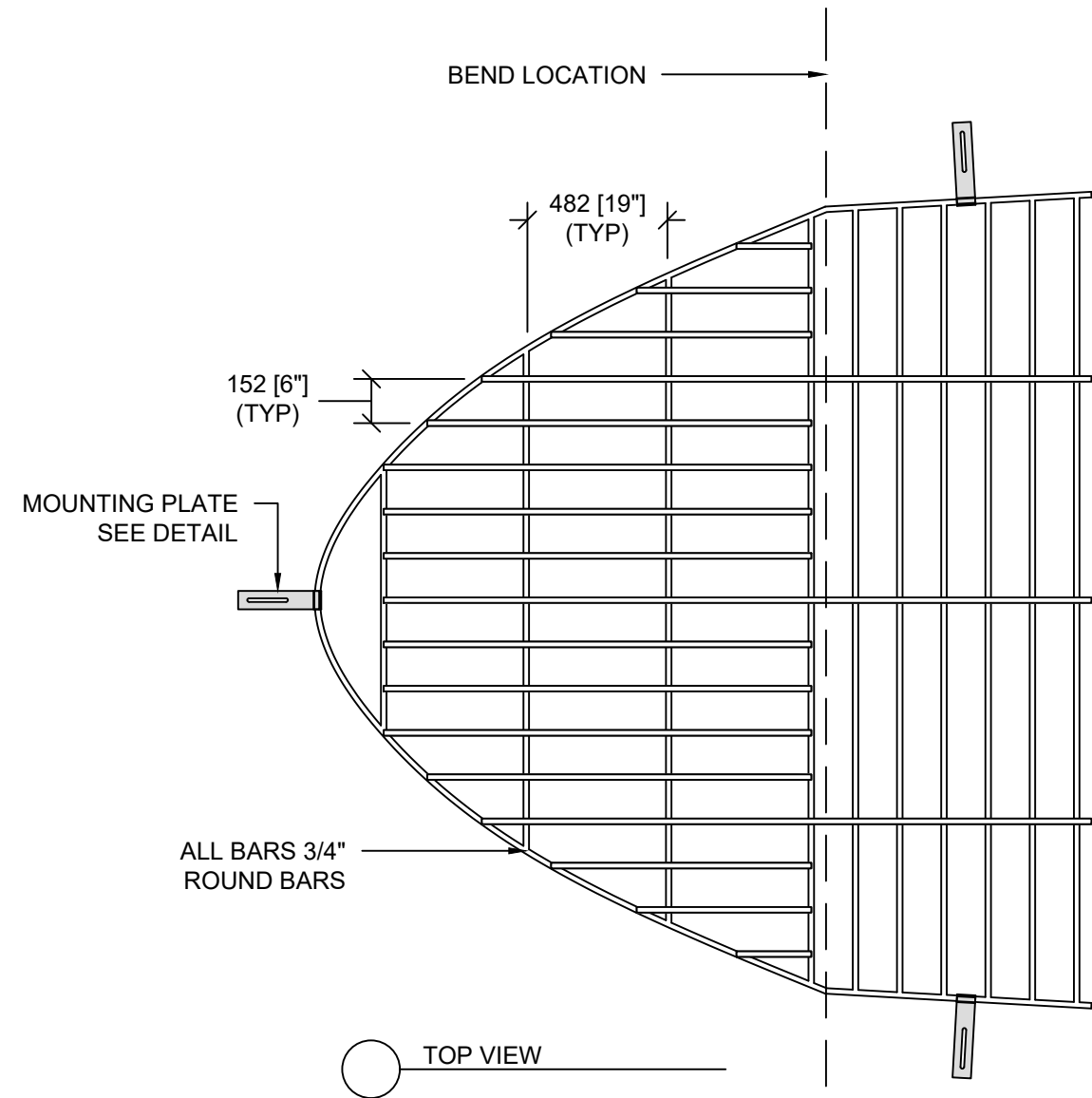

TOP VIEW

ALL BARS 3/4"  
ROUND BARS

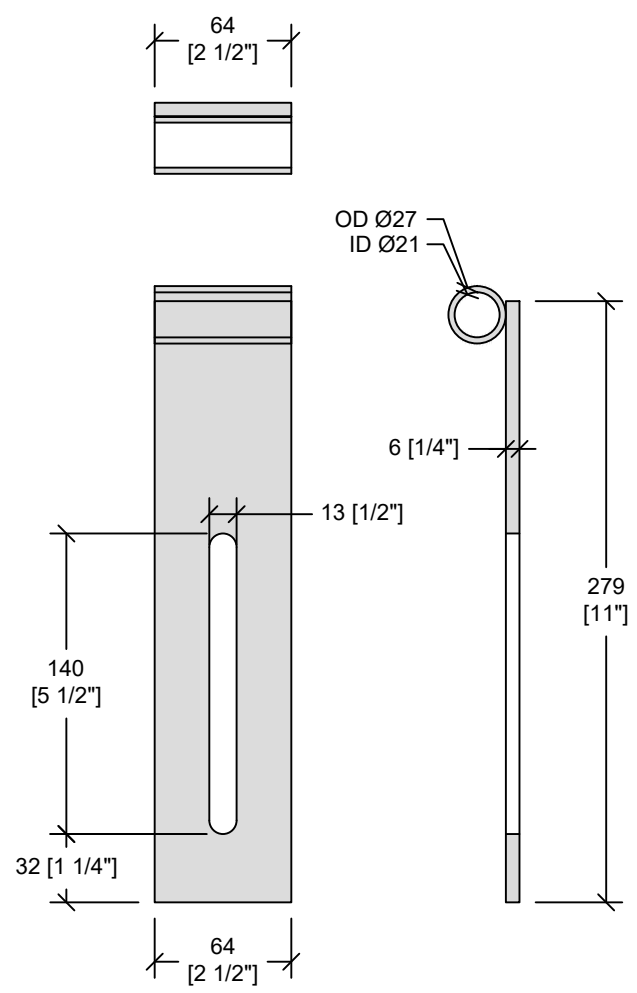

MOUNTING PLATE DETAIL

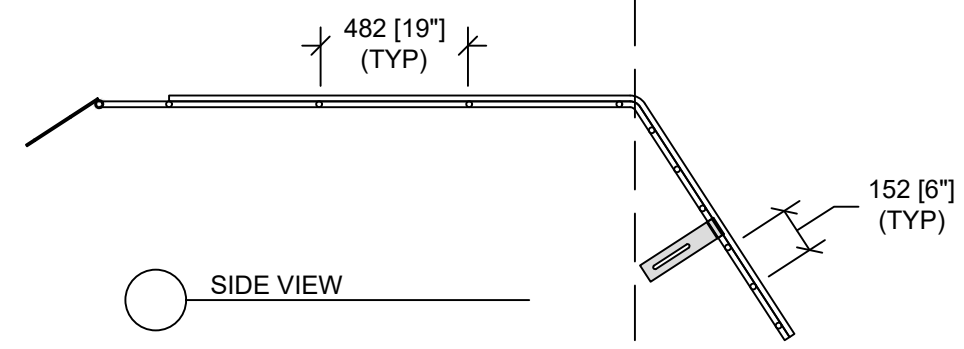

SIDE VIEW



SHEET TITLE

**Ø1500 FLARED END  
BAR SCREEN**

PROJECT NAME

-----

CONTRACTOR

-----

DRAWN BY	DANIEL ROWE
CHECKED BY	-
JOB NUMBER	-----
REVISION	REV. 00
DATE	August 22, 2023

- ISSUED FOR APPROVAL
- ISSUED FOR CONSTRUCTION