

AVAILABLE OPENING SIZES: 635mm, 710mm, 914mm, 1219mm,
AND CUSTOM HATCHES

HORIZONTAL INSTALLATION
VERTICAL INSTALLATION

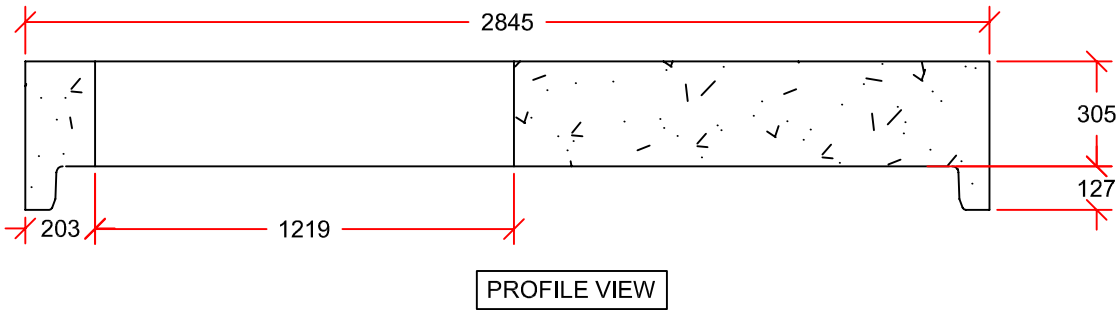

DRAWN BY:	KIM PHAM
SCALE:	NTS
DATE:	NOV. 5, 2015
DRAWING #:	2400mm x 1800mm SLAB TOP/CAP
REVISION #:	REV. 1
CHECKED BY:	TYSON DYCK

2400mm x 1800mm SLAB TOP/CAP

DIMENSIONS IN mm. APPROX MASS 4859 KG. FOR VERTICAL INSTALLATION, 4 SWIFT LIFT PINS ON TOP SURFACE OF SLAB TOP. FOR HORIZONTAL INSTALLATION, 2 SWIFT LIFT PINS ON THE TOP SIDE OF CAP. SWIFT LIFT LOCATION MAY VARY DEPENDING ON SIZE OF OPENING.

INLAND
Pipe

7336 112th AVE NW. CALGARY, AB.
PH: 403-2795531 FAX: 403-279-7648