

AVAILABLE IN 0.46m, 0.61m, 0.92m,
1.22m, 1.83m, AND 2.44m LENGTHS

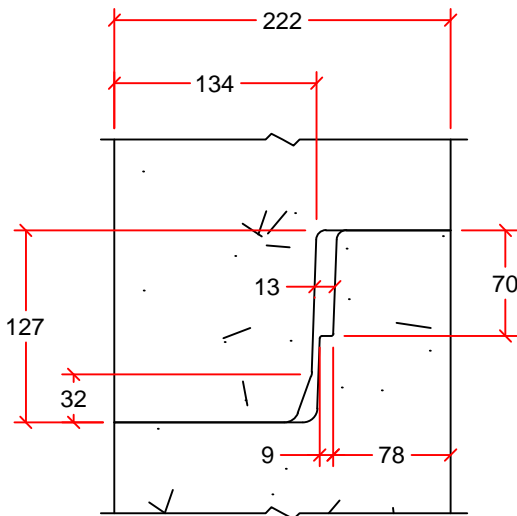

JOINT DETAIL

| HEIGHT (H) (mm) | MASS (kg) | NUMBER OF PINS | LOAD RATING | D (mm) |
|--------------------|--------------|-------------------|----------------|--------|
| 460 | 3780 | 2 | 8T | 152 |
| 610 | 4330 | 2 | 8T | 254 |
| 920 | 5460 | 2 | 8T | 254 |
| 1220 | 6555 | 2 | 8T | 254 |
| 1830 | 8785 | 4 | 8T | 457 |
| 2440 | 11010 | 4 | 8T | 457 |

| | |
|-------------|-------------------|
| DRAWN BY: | SAM HAN |
| SCALE: | NTS |
| DATE: | NOVEMBER 12, 2015 |
| DRAWING #: | 2100mm MH BASE |
| REVISION #: | REV. 1 |
| CHECKED BY: | TYSON DYCK |

| | |
|-------------------------------------|--|
| 2100mm MANHOLE BASE | |
| DIMENSIONS IN mm INNER POUR BASE | |

INLAND
Pipe

2494 FERRIER ST. WINNIPEG, MB.
PH: 204 334-4300 FAX: 204 334-7957