

AVAILABLE IN 0.46m, 0.61m, 0.92m,
1.22m, 1.83m, AND 2.44m LENGTHS

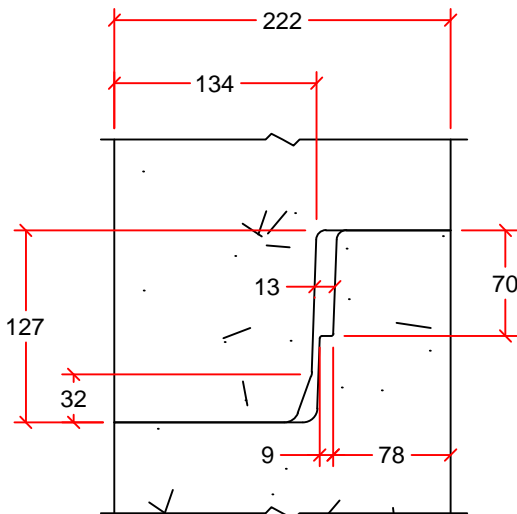

JOINT DETAIL

HEIGHT (H) (mm)	MASS (kg)	NUMBER OF PINS	LOAD RATING	D (mm)
460	3780	2	8T	152
610	4330	2	8T	254
920	5460	2	8T	254
1220	6555	2	8T	254
1830	8785	4	8T	457
2440	11010	4	8T	457

DRAWN BY:	SAM HAN
SCALE:	NTS
DATE:	NOVEMBER 12, 2015
DRAWING #:	2100mm MH BASE
REVISION #:	REV. 1
CHECKED BY:	TYSON DYCK

2100mm MANHOLE BASE	
DIMENSIONS IN mm INNER POUR BASE	

INLAND
Pipe

3000 10th AVE. REGINA, SK.
PH: 204 334-4300 FAX: 204 334-7957