

MAXIMUM PIPE SIZE FOR STRAIGHT THROUGH INSTALLATION

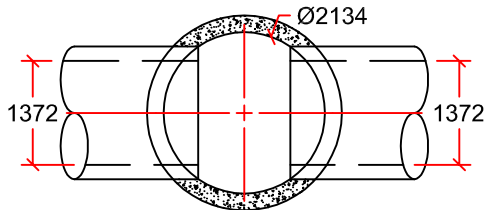

MAXIMUM PIPE SIZE FOR RIGHT ANGLE INSTALLATION

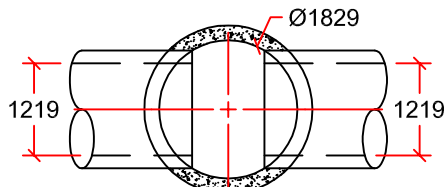
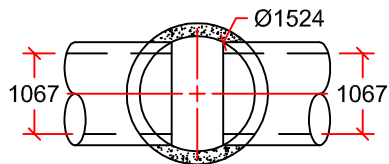
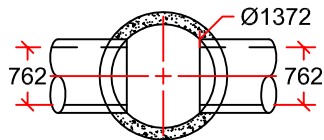
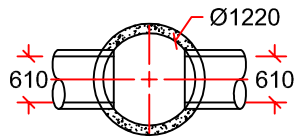
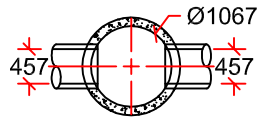
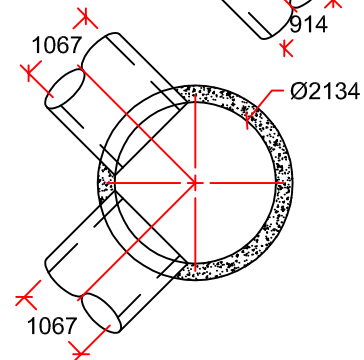
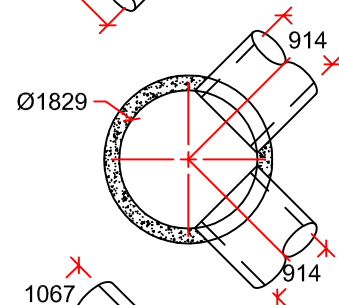
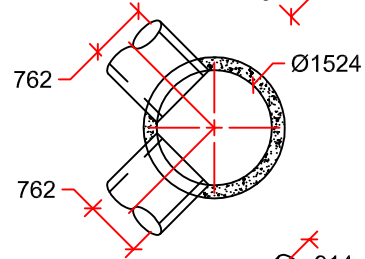
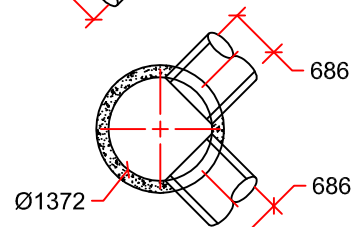
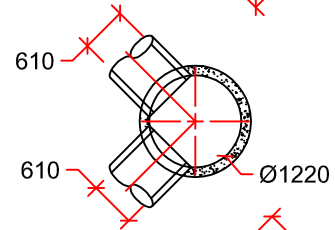
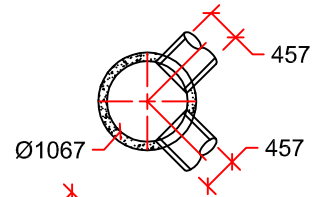

DRAWN BY:	AARON KLEMETS
SCALE:	NTS
DATE:	NOVEMBER 12, 2015
DRAWING #:	MAX MH 1050-2100
REVISION #:	REV. 0
CHECKED BY:	TYSON DYCK

MAXIMUM PIPE SIZES FOR MANHOLES
1050MM THROUGH 2100MM MANHOLES
NON-STANDARD ANGLES POSSIBLE, CALL FOR SPECIFIC PROJECT SITUATIONS



9265 OAK ST. VANCOUVER B.C.  
PH: 604 269-6700 FAX: 604 261-6751