



Stone-Hold cement

Product description

Heidelberg Material's Stone-Hold Premium cement is an excellent choice for today's stone construction applications. It provides optimal bond strength while maintaining exceptional workability. This proprietary formulation also improves resistance to cracking during freeze/thaw cycles. Why settle for less than the ideal? Ensure the long-term strength and esthetic value of your project with Heidelberg Materials Stone-Hold cement, formulated for stonework applications.

Key benefits/features

- Excellent durability
- Superior strength
- Enhanced adhesion
- Consistent workability
- Compatible with natural and manufactured stone for exterior or interior applications



Applications

Stone-Hold cement is a construction-grade cement designed for the installation of manufactured and natural stone. Stone-Hold can be used as a bond coat, scratch and brown coat, and as a mortar joint grout over concrete and masonry surfaces or galvanized, expanded metal lath. Stone-Hold cement for stonework should be used in accordance with local building codes. Consult all instructions and requirements provided by the stone manufacturer prior to installation.



Applicable standards

Stone-Hold cement meets the requirements of ASTM 91 and ASTM 1329.

Delivery/storage

Stone-Hold cement is packaged in 75 lb. (32kg) multi-walled bags. Packages should be kept free from moisture.

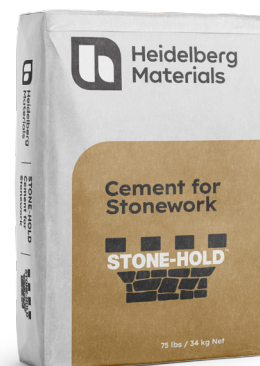

Material to build our future

Application

Ensure the mixing equipment is clean and in good working order. Provide a 1-cubic-foot box or other suitable container of volumetric measuring of aggregate. Aggregate shall conform to the requirements of ASTM C 144. Water shall be potable. Stone-Hold should be mixed with 2 ¼ to 3 cubic feet of sand, according to Table 1 Proportion Specification of ASTM C 270. Start the mixer, place ¾ of the required amount of water, ½ the required amount of sand and all the Stone-Hold into the mixer. Mix briefly. Add the remaining sand and water to the mixer and mix for a minimum of 3 and a maximum of 5 minutes after the last mix water has been added. Based on application experience, for every 100 square feet of stone surface, you will need an estimated 3 bags of Stone-Hold for stonework.

Using the following recommended formulations will reduce shrinkage cracks, and improve overall performance.

Mortar for Stonework

Mortar for wall and stone surface	Parts by volume	
	Stone-Hold Cement	Masonry Sand
	1	2½

Mortar for Grouting

Mortar for wall and stonework	Parts by volume	
	Stone-Hold Cement	Masonry Sand
	1	3



Stone installation

- Prepare surfaces properly. Consult stone veneer manufacturer's instructions.
- Apply ½ inch of mortar over CMU wall, sheathing or rigid insulation. (See diagram below)
- Apply ¾ inch of mortar to the back of each stone unit. Cover back completely.
- Press coated unit firmly on wall.
- Some mortar should be squeezed out around the stones' edges.
- Ensure complete coverage between vertical surface and back surface of the stone.

Finishing joints

- Use a grout bag to fill in joints.
- Avoid smearing on stone. Accidental smears should be removed only when dry. Use a dry brush.
- Finish joints when thumbprint dry with a metal or brush tool.

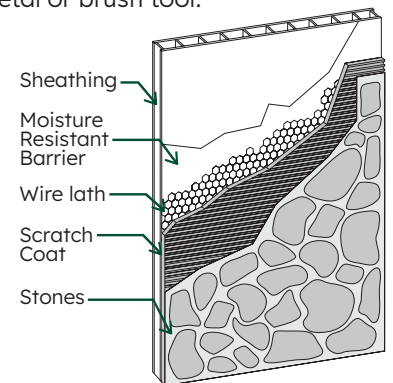

For more information on our company or our products, visit us online at:

heidelbergmaterials.us

Caution

This product, dry or wet, can cause irritation and severe burns to eyes and skin. Contains small amounts of crystalline silica, which has been listed as a human carcinogen. Also, repeated inhalation of crystalline silica can cause silicosis, a disabling and potentially fatal lung disease. Avoid contact with eyes or prolonged contact with skin. Wear eye protection, rubber boots and gloves. Cover arms and legs adequately. Use in a well ventilated area. Use a NIOSH-approved respirator in dusty conditions. Wash thoroughly after handling. In case of eye contact, flush with plenty of water for at least 15 minutes. Consult a physician immediately. For additional safety information reference our Safety Data Sheets online at heidelbergmaterials.us

Warranty

The information and statements herein are believed to be reliable, but are not to be construed as the warranty or representation for which we assume legal responsibility. Lehigh Masonry cements shall conform to the current Standard Specification for Masonry Cement, ASTM C91 and/or ASTM C1329, and no other warranty, representation of any kind, expressed or implied, (including no warranty of merchantability or fitness for a particular purpose) shall apply. Having no control over the use of cement, seller will not guarantee finished work, nor shall seller be liable for consequential damages.